

**SUGGESTIONS / FACTORS TO TAKE INTO CONSIDERATION**

BIANCO CARRARA	PIETRA D'AVOLA
<p>The small holes, commonly referred to as "tarolo", are a natural characteristic of Bianco Carrara which we encourage to be left open. Only in the case of tiling the inside of a shower or other areas in constant contact with water should the holes be filled with Mapei Keracolor FF White 100.</p> <p>The defining feature of Bianco Carrara in Cotone texture is its irregular delicate "scratched" effect.</p>	<p>Pietra d'Avola is a limestone with an irregular structure which includes a wide variation of tones which may seem almost stain-like in their appearance.</p> <p>The defining feature of Pietra d'Avola in Cotone texture is its irregular delicate "scratched" effect.</p>

In the stone sector, it is common to report nominal dimensions, applying the EC rules for which precise dimensional tolerances are set. This does not compromise the quality of the product nor will it create problems during installation.

**SUGGESTIONS / BEFORE BEGINNING**



Caution: a square metre of Cotone weighs approximately 27 kg. Take care to keep your back straight when lifting boxes. Take care to lift it up and lay it down on the ground while keeping your back straight.



Caution: wear the required protective clothing when accessing work areas. This will reduce the risk of personal injuries.



Unpack the tiles and check to see that they are in good condition. If there are any damages, do not proceed with installation. Notify your retailer within the specified timeline. Returns are not accepted once the tiles have been installed.



The material could arrive on site still damp (this is due to the use of water in the processing stages). As a result, the colour may appear darker. You can easily check to see if the material is damp by exposing it directly to a heat source for a few seconds. It should start to lighten visibly and return to its original tone.

**SUGGESTIONS / SPECIAL NOTES**



Caution: if you have a radiant underfloor heating system, we recommend keeping the system turned off for the duration of the various laying phases.

## COTONE INSTALLATION GUIDE

### LAYING PATTERN

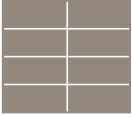

With the help of a designer, decide if you prefer an orthogonal laying pattern.



You may instead choose a running laying pattern. We recommend laying them either in a staggered pattern of 50:50 or with an offset of 33%. This will depend on your personal preference.

50:50 laying pattern

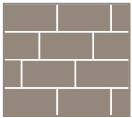

33% offset laying pattern

### DRY LAYING



Lay the tiles according to the pattern desired. Being a natural material, the tiles will not have a uniform colour, and therefore we advise you give some thought during this stage to how you mix the variations in tonality to give you the best overall effect.

### GLUING



Using a toothed trowel, spread a thin layer of adhesive on the laying surface.



Using a smooth trowel, spread a layer of adhesive on the entire rough face (back) of the tile.



Glue the tile to the surface.



Level the tiles with your hands or with a rubber mallet.

### ADHESIVE CLEANING



Lay the tiles according to the pattern desired. Being a natural material, the tiles will not have a uniform colour, and therefore we advise you give some thought during this stage to how you mix the variations in tonality to give you the best overall effect.

### RECOMMENDED ADHESIVES

	<b>BIANCO CARRARA</b>	<b>PIETRA D'AVOLA</b>
Installation on wood	Mapei Keralastic T white	Mapei Keralastic T grey
Installation on plasterboard	Mapei Elastorapid white	Mapei Elastorapid grey
Installation on concrete	Mapei Elastorapid white	Mapei Elastorapid grey

## COTONE INSTALLATION GUIDE

### SPACING AND GROUTING

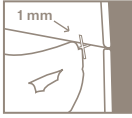

We recommend the minimum joint possible, ie around 1 mm.



Fill the spacing and cover the entire surface of the tile with grout.

### CLEANING OF GROUT MATERIAL

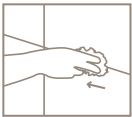

Remove the grout from the tile surface as soon as it starts to dry (within 5-30 minutes of laying).

### RECOMMENDED GROUT



BIANCO CARRARA	PIETRA D'AVOLA
Mapei Keracolor FF White 100	Mapei Keracolor FF Cement Grey 113

### CLEANING



Wash the laid surface with the specified product. For tiles which have been laid on the ground, we recommend the use of a single-disc floor machine, wet vacuum, mop or cloth. Once the surface has been thoroughly cleaned, wet it again and then evenly distribute FILA PS87 as indicated in the table below. Clean vigorously using a single-disc floor machine with a non-abrasive head or a broom covered with a cloth. If using the latter option, the cloth should be rinsed frequently in the FILA solution. Finally, clean the surface again with clean water using a wet vacuum if necessary.

BIANCO CARRARA	PIETRA D'AVOLA
FILA PS87 One 1 litre-bottle per 30 sqm.	FILA PS87 One 1 litre-bottle per 30 sqm.

### DRYING



Let dry 24-48 hours (may require longer, depending on the actual environment's conditions).

## FINAL TREATMENT

Once laying is complete, apply a water-oil-repellent product that will protect both the stone and the spacing. Follow the instructions on the package. If applying to a vertical surface, we recommend applying from the bottom upwards so as to avoid any drips. To prevent possible leakages of the product from staining the material, it is suggested to always apply from the bottom upwards.

### NOTE:

For surfaces in wet environments, after cleaning apply a coat of FILA HYDROREP, and after 24 hours proceed with the final treatment as indicated above. Do not use FILAMATT on flat surfaces with a high risk of slipping. FILA HYDROREP must not be applied to Pietra d'Avola.

	BIANCO CARRARA	PIETRA D'AVOLA
	<p>FILAFOB (solvent based) One 1 litre-bottle per 15 sqm for each coat. We recommend the application of two or more coats. Neutral protectant. Always follow the instructions on the package.</p>	<p>FILAFOB (solvent based) One 1 litre-bottle per 15 sqm for each coat. We recommend the application of two or more coats. Neutral protectant. Always follow the instructions on the package.</p>



Let dry for 24 - 48 hours before use.



After treatment, cover the area with a non-woven fabric so that the surface stays protected during the remaining installation phases. For flooring in particular, it is critical that you use several layers of fabric, so any breakages due to the continuous passage of workers do not uncover the stone and expose it to the possibility of staining or damage.

## ONGOING MAINTENANCE AND CLEANING

For routine maintenance of the surfaces, always use neutral cleansers (for example, FILACLEANER or neutral soap). Do not in any case use harsh products that could irreparably damage the surface of the stone (such as acids or descaling products).



We strongly recommend that you do not place hot objects such as kettles or pans directly onto natural stone as it may cause discolouration or staining.

If your stone is exposed to "hard water" where there is a high mineral content, you will need to take a little extra care as the cleaning properties of the FILACLEANER or neutral detergent will be weakened. You will therefore need to use these products a little more frequently so that soap scum, lime scale and the like do not have the chance to build up and congeal.

## GLOSSARY OF PRODUCTS

### ADHESIVE

MAPEI KERALASTIC T for installation on wood

MAPEI ELASTORAPID for installation on plasterboard and concrete

### GROUT

MAPEI KERACOLOR FF

### POST-LAYING CLEANING

FILA PS87: suitable for most types of stone, it is recommended for use during installation and for when particular maintenance is required

### FINAL TREATMENT

FILA HYDROREP: to be used for surfaces in wet environments (must not be used on Pietra d'Avola)

FILAFOB: neutral solvent-based protectant

### ONGOING CLEANING

FILACLEANER or neutral soap: a neutral cleaner for normal maintenance of stone surfaces